

TeacherGeek Build Guide

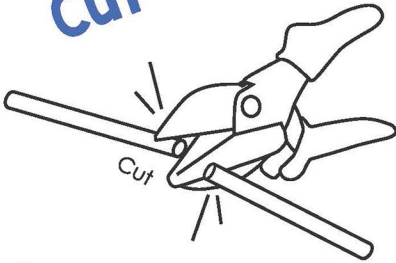

What do you need to know to make something out of TeacherGeek?

Cut



Multi-Cutters cut wood & plastic (like **dowels** and **connector strips**). They do not cut metal.

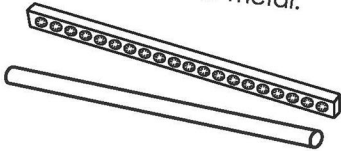

Push, Wiggle,

Push, wiggle or tap **dowels** into holes.



Tap

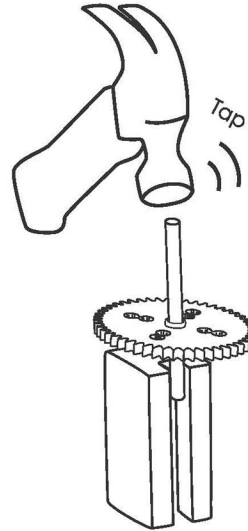

Use a **hammer** and **slider block** to tap **dowels** farther through holes.

Quick Tip!



Use a **crayon**, or **soap** on the end of a **dowel** to make building easier.

Ream

Most parts have holes with **teeth**. The **teeth** hold **dowels** (keep dowels from falling out).

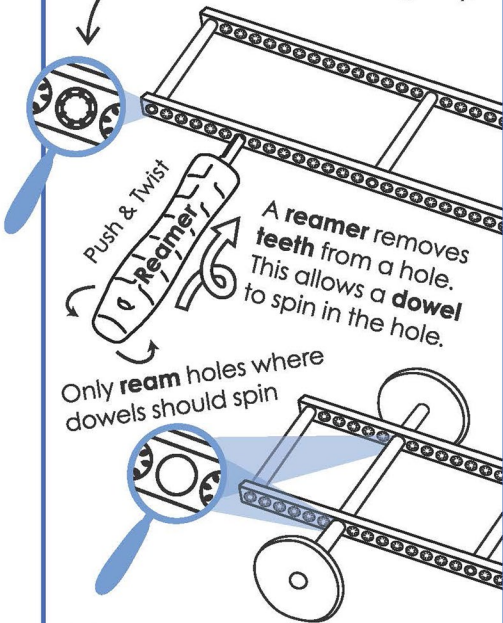

A **reamer** removes **teeth** from a hole. This allows a **dowel** to spin in the hole.

Only **ream** holes where dowels should spin

Never **ream** pulleys, gears, wheels, or any hole a **dowel** stays stuck into.

Screws & Nuts

Do not **ream** holes you will put **screws** into.

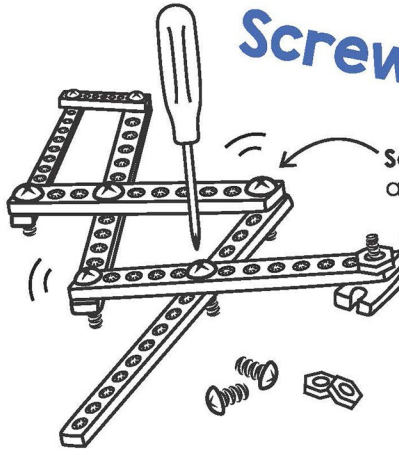

Screws (without nuts) can connect parts, and allow them to rotate.

Screws (with a nut) can connect parts, and keep them from rotating.

Stop Clip

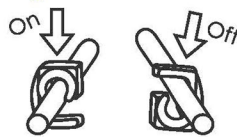

Press a **stop clip** onto a **dowel** to keep it from sliding or use it as a hook for a string / rubber band. It takes little force to get it on.

Slide Stop

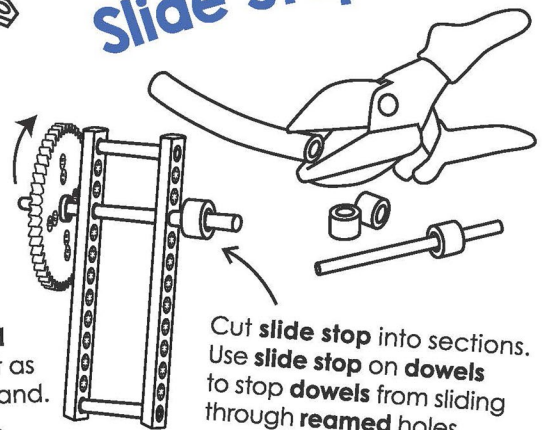

Cut **slide stop** into sections. Use **slide stop** on **dowels** to stop **dowels** from sliding through **reamed** holes.

More resources available at teachergeek.com.
Adult supervision required for children 12 and under.