



Electromagnet Crane "Super Sort" Challenge



The Challenge: Design an Electromagnet Crane to sort as many materials in 2 minutes as possible.

Difficulty: Medium

Redesign your crane to reach all of the sorting areas. The example crane will not work.

Add parts to your crane to help you move non-magnetic materials.

Move materials from the pile in the center, to the correct sorting areas.

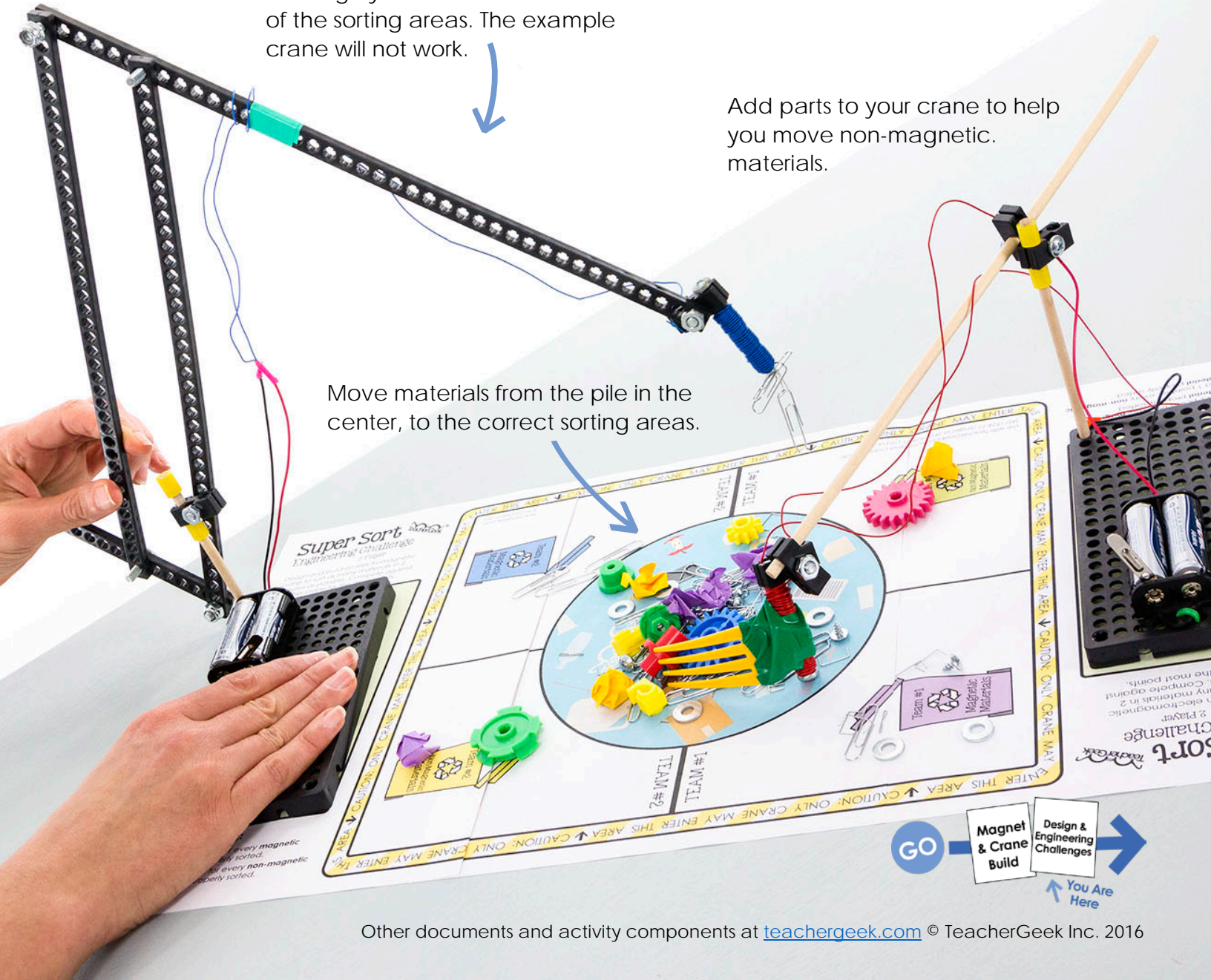

Magnet
& Crane
Build

Design &
Engineering
Challenges

You Are
Here



Electromagnet Crane "Super Sort" Challenge



Single Player Arena

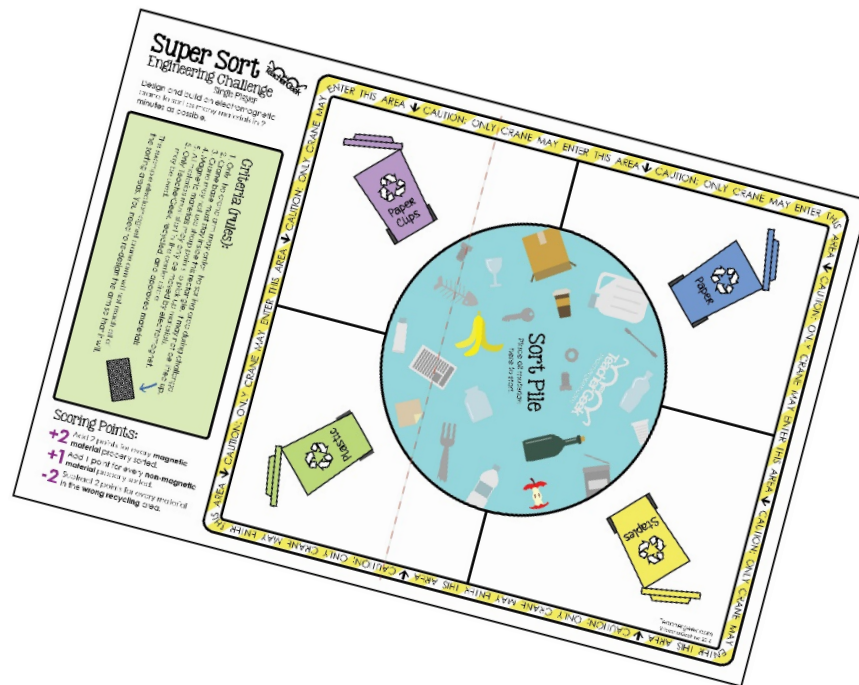

Super Sort

Engineering Challenge

TeacherGeek

Single Player

Design and build an electromagnetic crane to sort as many materials in 2 minutes as possible.

Criteria (rules):

1. Only the crane arm may enter the sorting area during the challenge.
2. Crane base must stay inside this rectangle. It may not be lifted up.
3. Crane may not use sharp points to pick up materials.
4. Magnetic materials may only be moved by electromagnet.
5. All materials must start in the center circle.
5. Only TeacherGeek, recycled, and approved materials may be used.

The example electromagnet crane arm will not reach all of the sorting areas. You need to redesign the arm so that it will.



Scoring Points:

- +2** Add 2 points for every **magnetic material** properly sorted.
- +1** Add 1 point for every **non-magnetic material** properly sorted.
- 2** Subtract 2 points for every material in the **wrong recycling area**.

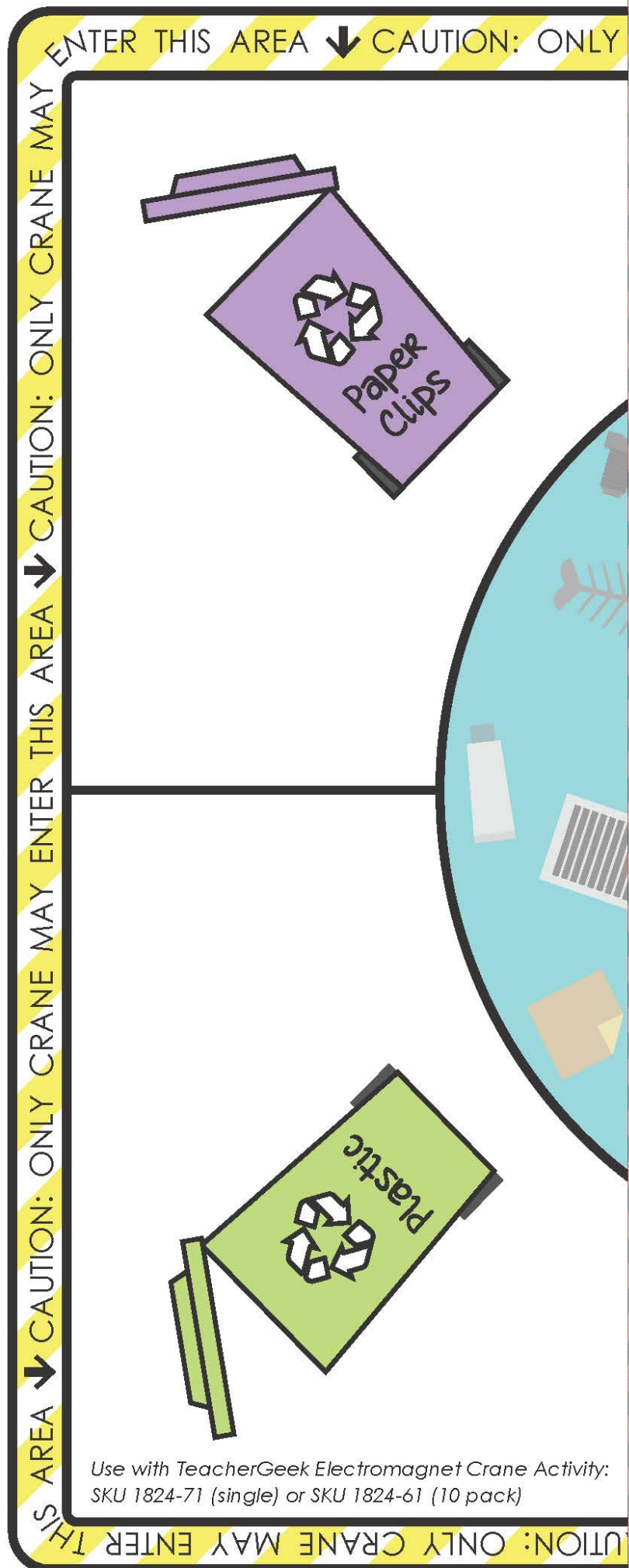



Electromagnet Crane "Super Sort" Challenge



Two Player Arena

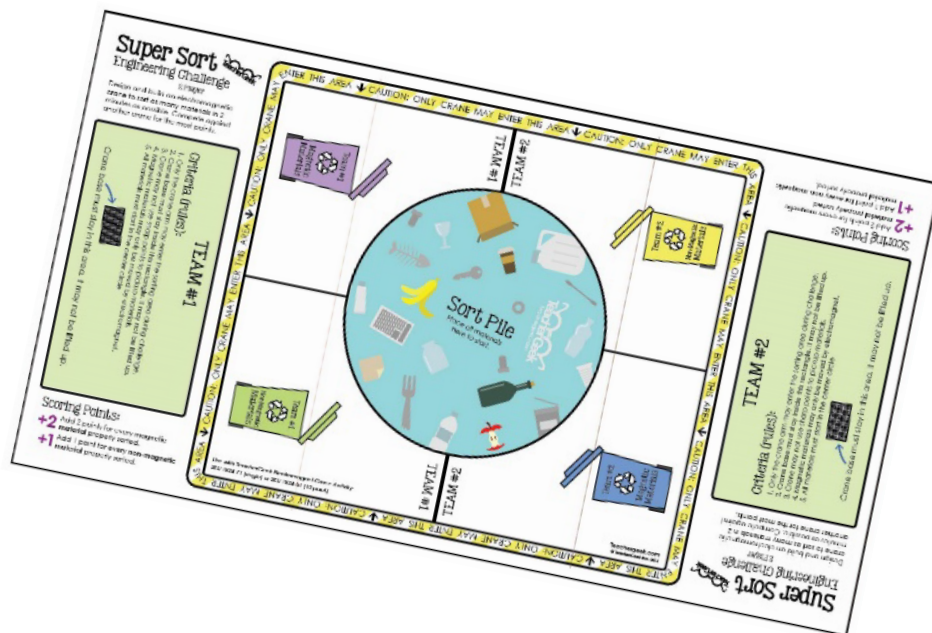

Super Sort Engineering Challenge

2 Player

Design and build an electromagnetic crane to sort as many materials in 2 minutes as possible. Compete against another crane for the most points.

TEAM #2

Criteria (rules):

1. Only the crane arm may enter the sorting area during the challenge.
2. Crane base must stay inside this rectangle. It may not be lifted up.
3. Crane may not use sharp points to pick up materials.
4. Magnetic materials may only be moved by electromagnet.
5. All materials must start in the center circle.
5. Only TeacherGeek, recycled, and approved materials may be used.

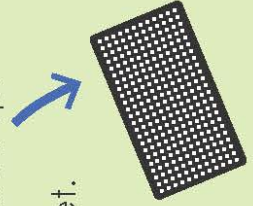

The example electromagnet crane arm will not reach all of the sorting areas. You need to redesign the arm so that it will.

Scoring Points:
+2 Add 2 points for every **magnetic** material properly sorted.
+1 Add 1 point for every **non-magnetic** material properly sorted.

Cut and attach to center sheet.

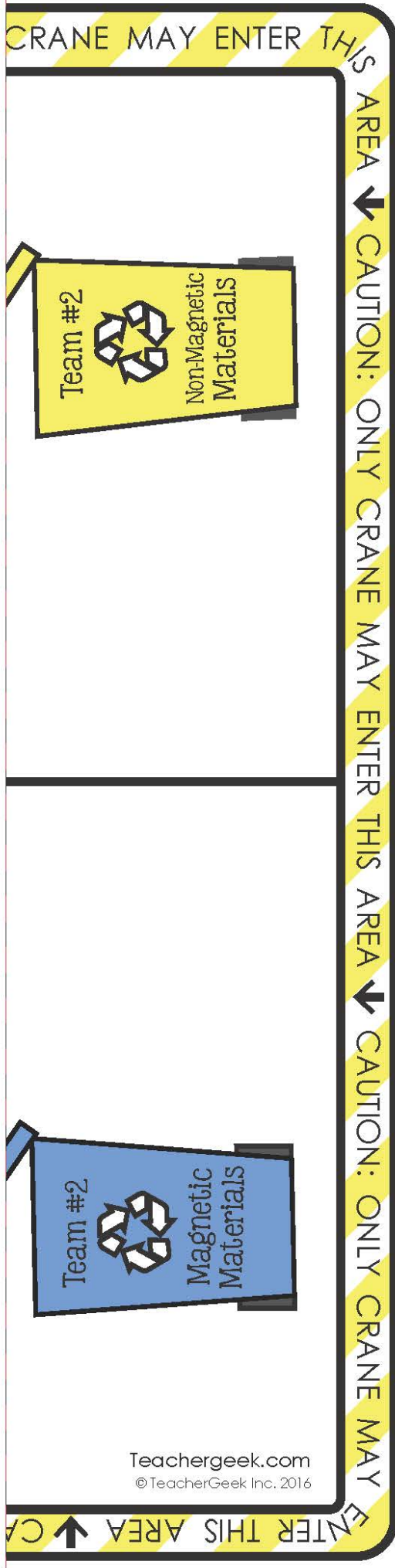

Super Sort



Engineering Challenge

2 Player

Design and build an electromagnetic crane to sort as many materials in 2 minutes as possible. Compete against another crane for the most points.

Criteria (rules):

TEAM #1

1. Only the crane arm may enter the sorting area during the challenge.
2. Crane base must stay inside this rectangle. It may not be lifted up.
3. Crane may not use sharp points to pick up materials.
4. Magnetic materials may only be moved by electromagnet.
5. All materials must start in the center circle.
5. Only TeacherGeek, recycled, and approved materials may be used.

The example electromagnet crane arm will not reach all of the sorting areas. You need to redesign the arm so that it will.

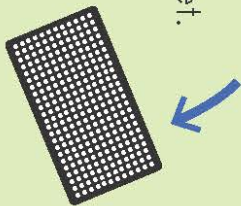

Scoring Points:

- +2** Add 2 points for every **magnetic material** properly sorted.
- +1** Add 1 point for every **non-magnetic material** properly sorted.



Cut and attach to center sheet.

Use with TeacherGeek Electromagnet Crane
SKU 1824-71 (single) or SKU 1824-72 (double)

CAUTION: ONLY CRANE MAY ENTER THIS AREA ⬇ CAUTION: ONLY

TEAM #1

TEAM #2



TEAM #1

TEAM #2

Magnet Crane Activity:
51 (10 pack)

CAUTION: ONLY CRANE MAY ENTER THIS AREA ⬆ CAUTION: ONLY

Glue or tape side team #1 sheet here.

Glue or tape side team #2 sheet here.